



A giant plinth has arrived in the play park in Shieldfield!
But the delivery men have forgotten to drop off the artwork for it...

Design a new **PUBLIC SCULPTURE** for Shieldfield
to sit on top of the plinth!



FAMOUS MASCOTS
KINGSLEY
BOILER MAN!
NYANGO STAR

Shieldfield needs a mascot. It has a lot of things, but it doesn't have a mascot. The mascot can be anything you want it to be - but needs to represent Shieldfield, bring some fun, and bring good luck!

Design Shieldfield a new mascot here:

Blank space for drawing a new mascot.

Your mascot is called:



Your mascot is hungry. They've gone to Subway for a footlong, draw their favourite Subway order:



Draw what your mascot's sworn enemy looks like:



Draw your mascot hanging out with their friends in their favourite place in Shieldfield:

Large blank space for drawing the mascot with friends in their favourite place.

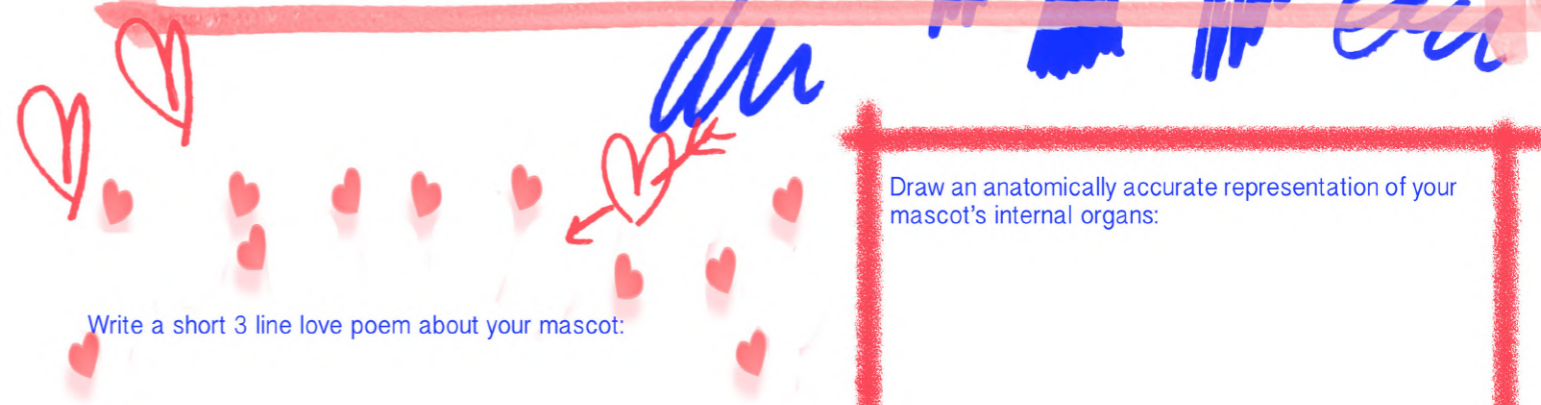

Write a short 3 line love poem about your mascot:

To:

From:



Draw an anatomically accurate representation of your mascot's internal organs:

Blank space for drawing the mascot's internal organs.



This big sculpture
on a big hill is standing
on a big secret.

Draw what lies
beneath it underground:

Side wall 1

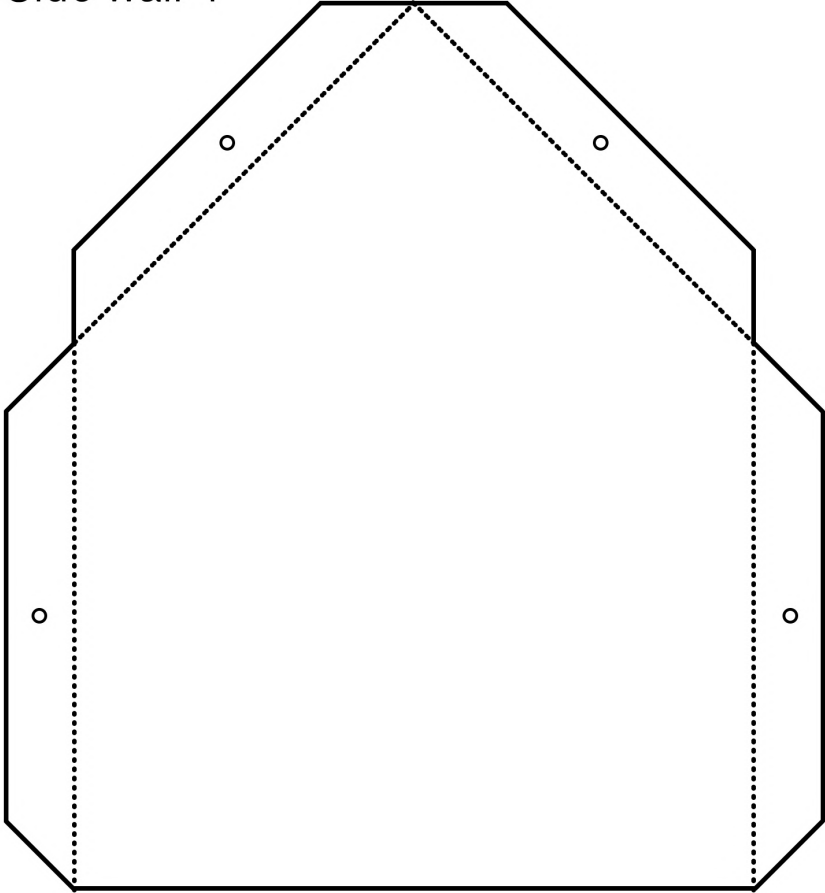

Side wall 2

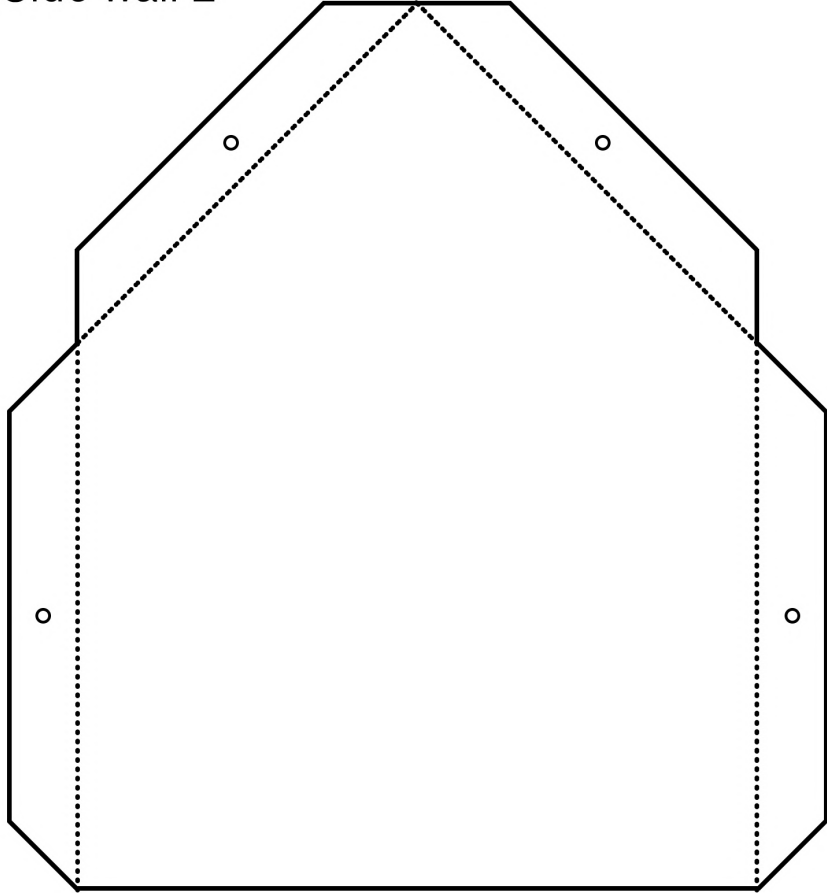

Chimney

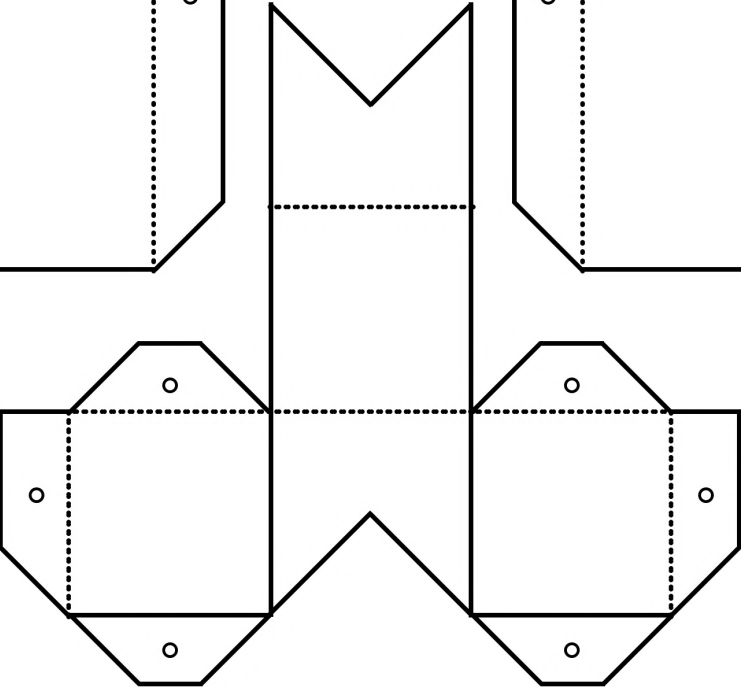

Roof

Front wall

--

Back wall



--

Design a new building for Shieldfield

You've been given the keys to an empty building in Shieldfield - Make it your own!

What do you want it to be? What would be inside?
What would it be made from? What colour would it be?
How many doors and windows would it have?
Does it have a sign?

Instructions:



1. Decorate your new building with colouring pencils.
2. Cut along solid lines. 
3. Fold along dotted lines. 
4. Glue tabs marked with an: 
5. Attach the Front wall and Back wall to the tabs on each Side Wall.
6. Attach Roof 1 and Roof 2 to the tabs on each Side Wall.
7. Place the Chimney on the top of the Roof.

Design a new building for Shieldfield

You've been given the keys to an empty building in Shieldfield - Make it your own!

What do you want it to be? What would be inside?
What would it be made from? What colour would it be?
How many doors and windows would it have?
Does it have a sign?

Instructions:



1. Decorate your new building with colouring pencils.
2. Cut along solid lines. 
3. Fold along dotted lines. 
4. Glue tabs marked with an: 
5. Attach the Front wall and Back wall to the tabs on each Side Wall.
6. Attach Roof 1 and Roof 2 to the tabs on each Side Wall.
7. Place the Chimney on the top of the Roof.

Design a new building for Shieldfield

You've been given the keys to an empty building in Shieldfield - Make it your own!

What do you want it to be? What would be inside?
What would it be made from? What colour would it be?
How many doors and windows would it have?
Does it have a sign?

Instructions:



1. Decorate your new building with colouring pencils.
2. Cut along solid lines. 
3. Fold along dotted lines. 
4. Glue tabs marked with an: 
5. Attach the Front wall and Back wall to the tabs on each Side Wall.
6. Attach Roof 1 and Roof 2 to the tabs on each Side Wall.
7. Place the Chimney on the top of the Roof.

Design a new building for Shieldfield

You've been given the keys to an empty building in Shieldfield - Make it your own!

What do you want it to be? What would be inside?
What would it be made from? What colour would it be?
How many doors and windows would it have?
Does it have a sign?

Instructions:

1. Decorate your new building with colouring pencils.
2. Cut along solid lines. 
3. Fold along dotted lines. 
4. Glue tabs marked with an: 
5. Attach the Front wall and Back wall to the tabs on each Side Wall.
6. Attach Roof 1 and Roof 2 to the tabs on each Side Wall.
7. Place the Chimney on the top of the Roof.